

Blueair by BLUENIX

MODEL BOD-48S

OPEN DISPLAY CASES

Sleek and durable cooling solution for
your food and beverages.



Conforms to NSF/ANSI 7(ETL)

MODEL BOD-48S

OPEN DISPLAY CASES

Exterior Dimensions
(inches/mm)

| L | D | H |
|--------------------|-------------------|--------------------|
| 48 1/8" 1221 mm | 32 1/2" 826 mm | 80 1/8" 2035 mm |

Weight
(lbs/kg)

| Net Weight | Ship Weight |
|------------------|-------------------|
| 525 lbs 238kg | 569 lbs 258 kg |

Blueair by
BLUENIX

Blue Air has right to change specifications without further notice.

Cabinet construction

- Pre-coated steel interior and exterior
- High density foamed in place polyurethane insulation - Environmentally safe
- Perforated interior rear wall and top vents for more efficient air circulation cooling
- Standard night curtain
- Four (4) 1" height adjustable shelves

Refrigeration

- R-404A Refrigerant.
- Self-contained system, bottom mounted compressor provides quick and easy maintenance.
- Innovative hot gas frame heating system reduces condensation and increases energy efficiency.
- Front air intake and rear air vent circulation system.
- Temperature range between 38°F ~ 44°F

Optional Features & Accessories

- Glass side panel

Front view

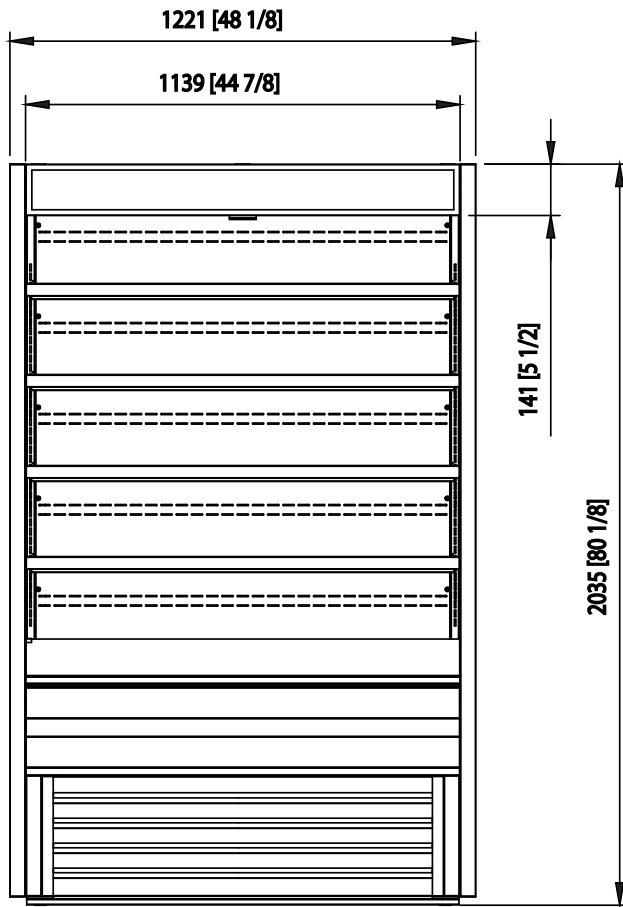

Side view

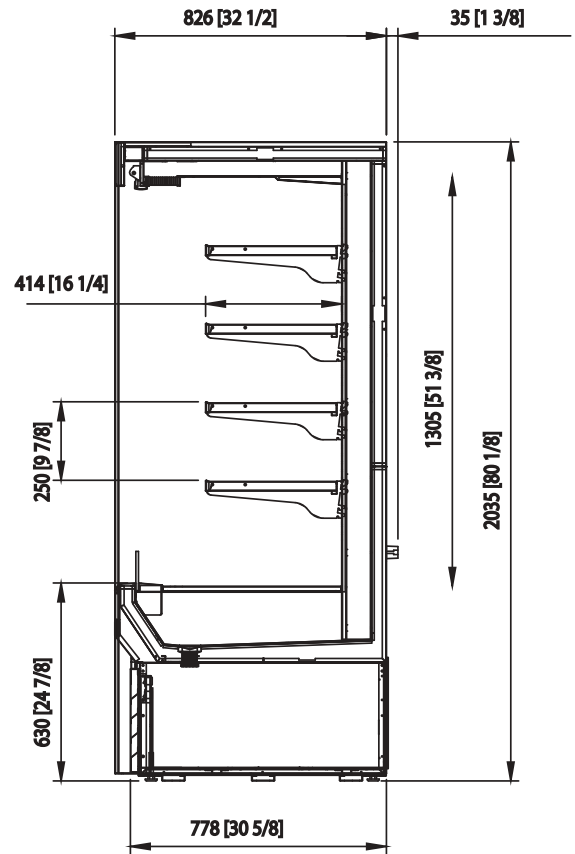

Top view

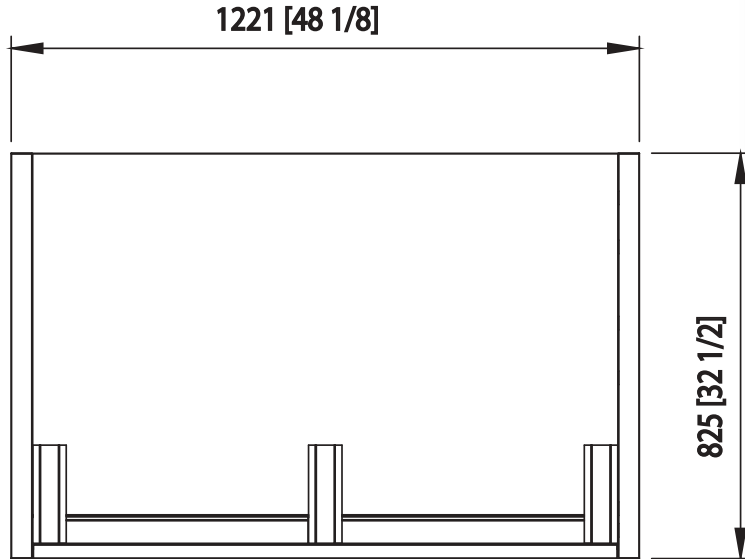

| | |
|-------------------|---|
| Capacity Cu.Ft. | 26.8 |
| Shelves | 4 |
| Refrigerant | R-404 A |
| Temperature Range | 38°F ~ 44°F |
| Easy Maintenance | Sliding Condensing Unit |
| Connection | 9.8 ft long (3m) flexible three wire cord with modeled plug |
| Lighting | LED Interior lighting |
| HP | 1 |
| Voltage | 115V/60Hz |
| Amps | 16.5 |
| NEMA Config. | NEMA 5-20 |



- This product may expose you to chemicals including Diisononyl Phthalate(DINP), which is known to the State of California to cause cancer. For more information go to www.P65Warnings.ca.gov.
 - Ce produit peut vous exposer à des agents chimiques incluant le Diisononyl Phthalate(DINP), reconnu par l'Etat de Californie comme causant le cancer, Pour de plus amples renseignements, consulter le site www.P65Warnings.ca.gov.



blueairfse.com



orders@blueairfse.com



223 W. Rosecrans Ave., CA 90248
 T: 310-808-0102

9 W. Shelton Terrace #A, Hillside, NJ 07205
 T: 470-625-0182

7025 Amwiler industrial Drive, Suite A, Atlanta GA
 T: 908-688-0970