

*Blueair* by  
**BLUENIX**

**MODEL BOD-36S**

**OPEN  
DISPLAY CASES**

Sleek and durable cooling solution for  
your food and beverages.



Conforms to NSF/ANSI 7(ETL)



## MODEL BOD-36S

OPEN DISPLAY CASES

Exterior Dimensions  
(inches/mm)

L	D	H
36 1/8" 916 mm	32 1/2" 826 mm	80 1/8" 2035 mm

Weight  
(lbs/kg)

Net Weight 437 lbs 198 kg	Ship Weight 483 lbs 217 kg
---------------------------------	----------------------------------

## Cabinet construction

- Pre-coated steel interior and exterior
- High density foamed in place polyurethane insulation - Environmentally safe
- Perforated interior rear wall and top vents for more efficient air circulation cooling
- Standard night curtain
- Four (4) 1" height adjustable shelves

## Refrigeration

- R-404A Refrigerant.
- Self-contained system, bottom mounted compressor provides quick and easy maintenance.
- Innovative hot gas frame heating system reduces condensation and increases energy efficiency.
- Front air intake and rear air vent circulation system.
- Temperature range between 38°F ~ 44°F

## Optional Features & Accessories

- Glass side panel

*Blueair* by  
**BLUENIX**

Blue Air has right to change specifications without further notice.

Front view

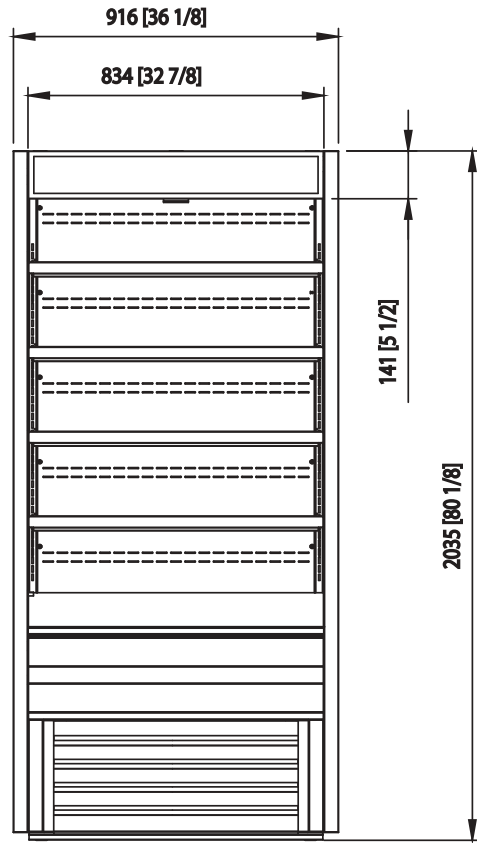

Side view

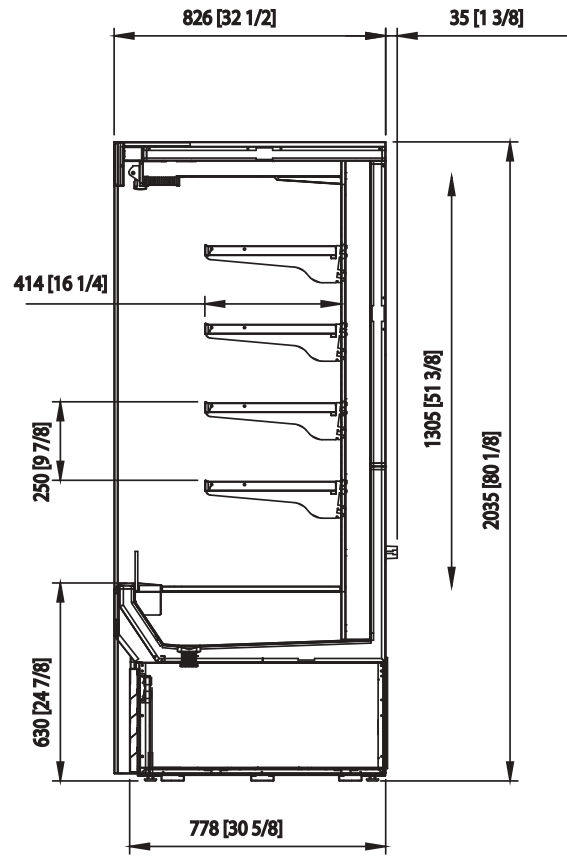

Top view

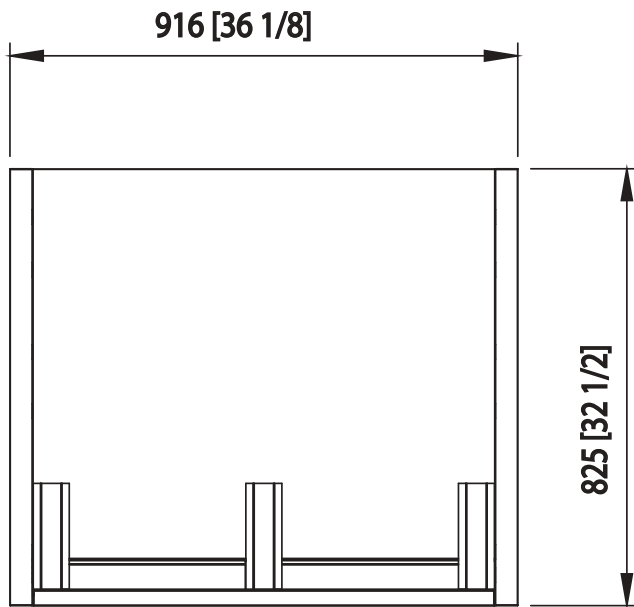

Capacity Cu.Ft.	19.6
Shelves	4
Refrigerant	R-404 A
Temperature Range	38°F ~ 44°F
Easy Maintenance	Sliding Condensing Unit
Connection	9.8 ft long (3m) flexible three wire cord with modeled plug
Lighting	LED Interior lighting
HP	1
Voltage	115V/60Hz
Amps	16.5
NEMA Config.	NEMA 5-20



- This product may expose you to chemicals including Diisononyl Phthalate(DINP), which is known to the State of California to cause cancer. For more information go to [www.P65Warnings.ca.gov](http://www.P65Warnings.ca.gov).  
 - Ce produit peut vous exposer à des agents chimiques incluant le Diisononyl Phthalate(DINP), reconnu par l'Etat de Californie comme causant le cancer, Pour de plus amples renseignements, consulter le site [www.P65Warnings.ca.gov](http://www.P65Warnings.ca.gov).



[blueairfse.com](http://blueairfse.com)



[orders@blueairfse.com](mailto:orders@blueairfse.com)



223 W. Rosecrans Ave., CA 90248  
 T: 310-808-0102

9 W. Shelton Terrace #A, Hillside, NJ 07205  
 T: 470-625-0182

7025 Amwiler industrial Drive, Suite A, Atlanta GA  
 T: 908-688-0970