



SPEEDER (86")

Double Tank Rack Conveyor Dishwasher

 277 Racks Per Hour | 20" x 20"

 CrossFire Wash System

 Includes pre-wash cycle

 Made in the USA

STANDARD FEATURES

- Color-coded curtains
- Capillary thermometers for wash and rinse
- In-line thermometer for final rinse
- Vacuum breaker on all incoming water lines
- Manifold clean-out brush
- Inspection door
- Ventilation fan connection provision
- Stainless steel frame, legs and feet
- Stainless steel front enclosure panel
- Automatic tank fill
- Low water protection
- Detergent connection provision
- Elevated top mounted NEMA 12 control panel
- Easily-cleaned crowned hood top
- Door safety switch
- Standard frame drip proof motors
- Override switch for de-liming
- Timing belt conveyor drive

OPTIONS

- Stainless steel steam coil tank heat
- Steam booster
- Electric booster
- Single point electrical connection: motors, controls and tank heat. (Booster requires a separate connection)
- End cowls with vent and adjustable damper controls
- Stainless steel splash guards
- Security package
- Totally enclosed motors
- Rack limit switch
- Power Loader
- Power Unloader
- Door activated drain closers
- Insulated hood and door
- Extra high hood
- Steam pressure release valve
- Drain water cooldown
- Plastic 20" x 20" racks (plate or silver)

SPECIFIER STATEMENT

Specified unit will be an Insinger Speeder 86 double tank rack conveyor dishwasher with pre-wash. Features include CrossFire Wash System, capillary thermometer for wash and rinse, in-line thermometer for final rinse, vacuum breaker, inspection door automatic tank fill, low water protection, door safety switch, energy saver, timing belt conveyor drive, and 304 stainless steel construction.



SPECIFICATIONS

Capacity	Racks Per Hour	277
	Dishes Per Hour	6925
	Meals Per Hour	300-600
Heating & Venting	Wash Tank Heat	7.5 kW
	Rinse Tank Heat	15 kW
	Booster Heat (40°F Rise)	15 kW
	Booster Heat (70°F Rise)	27 kW
	Venting (Load End)	350 CFM
	Venting (Unload End)	350 CFM
Water	Water Inlet Temperature	110°F
	Water Consumption (20 PSI)	.52 gal/rack
	Wash Tank Capacity	12 gal
	Peak Drain Flow	14 gal/min

Steam	Steam Tank Consumption (20 PSI)	81 lbs/hr
	Steam Consumption (20 PSI, 40°F Rise)	51 lbs/hr
	Steam Consumption (20 PSI, 70°F Rise)	90 lbs/hr
Other	Drive Motor HP	1/15
	Wash Motor HP	1.0
	Rinse Motor HP	1.0
	Shipping Weight	1200 lbs

TECHNICAL DRAWINGS

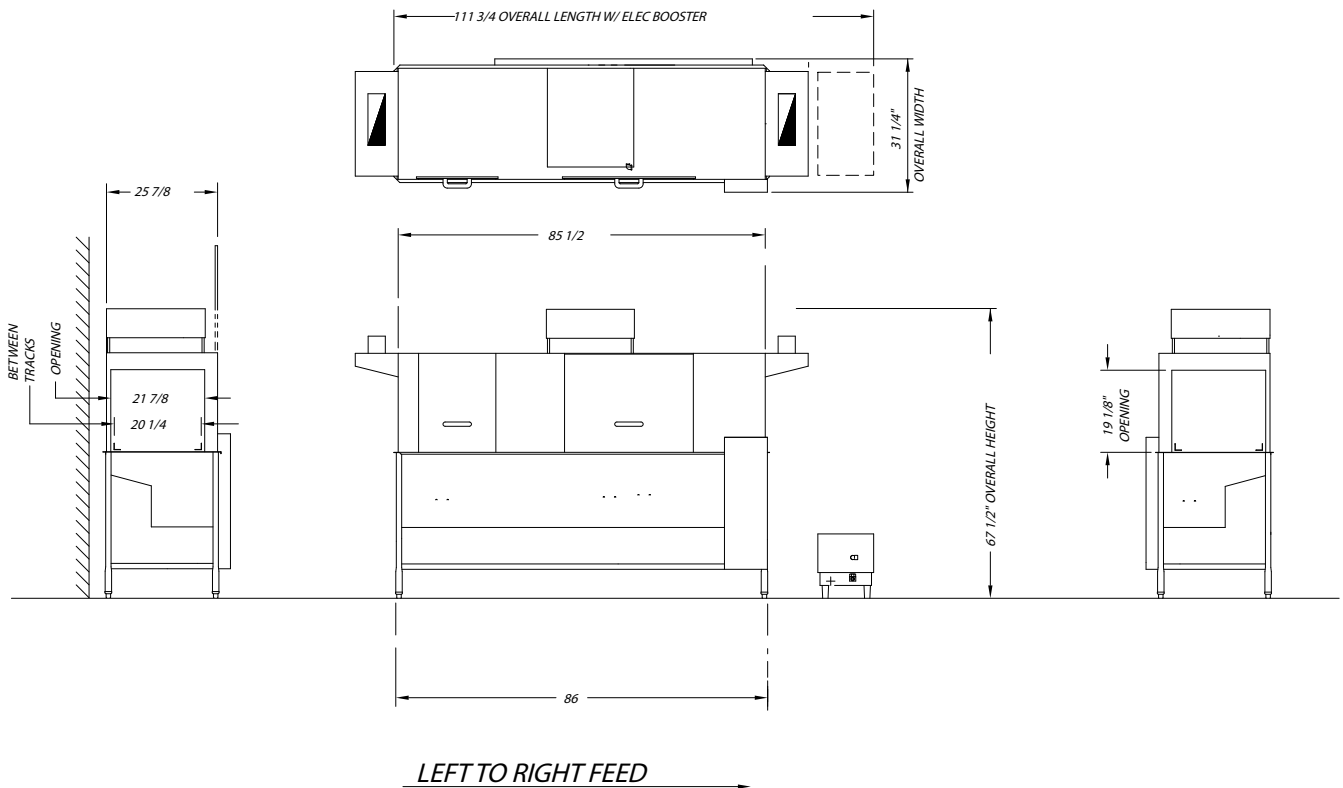

Contact Ininger Sales at 800-344-4802 for an installation drawing specific to your application.
 Note: Due to product improvement we reserve the right to change information and specifications without notice.

ELECTRICAL

	Electric (Speeder 86)	15 kw Booster	27 kw Booster	Steam	
Electrical Options	208/60/3	73.1 amps	41.7 amps	75 amps	10.7 amps
	240/60/1	112.8 amps	62.5 amps	112.5 amps	9.7 amps
	240/60/3	63.9 amps	36.1 amps	65 amps	9.8 amps
	380/50/3	40.0 amps	Contact Factory		5.9 amps
	480/60/3	31.9 amps	18.1 amps	32.5 amps	4.9 amps

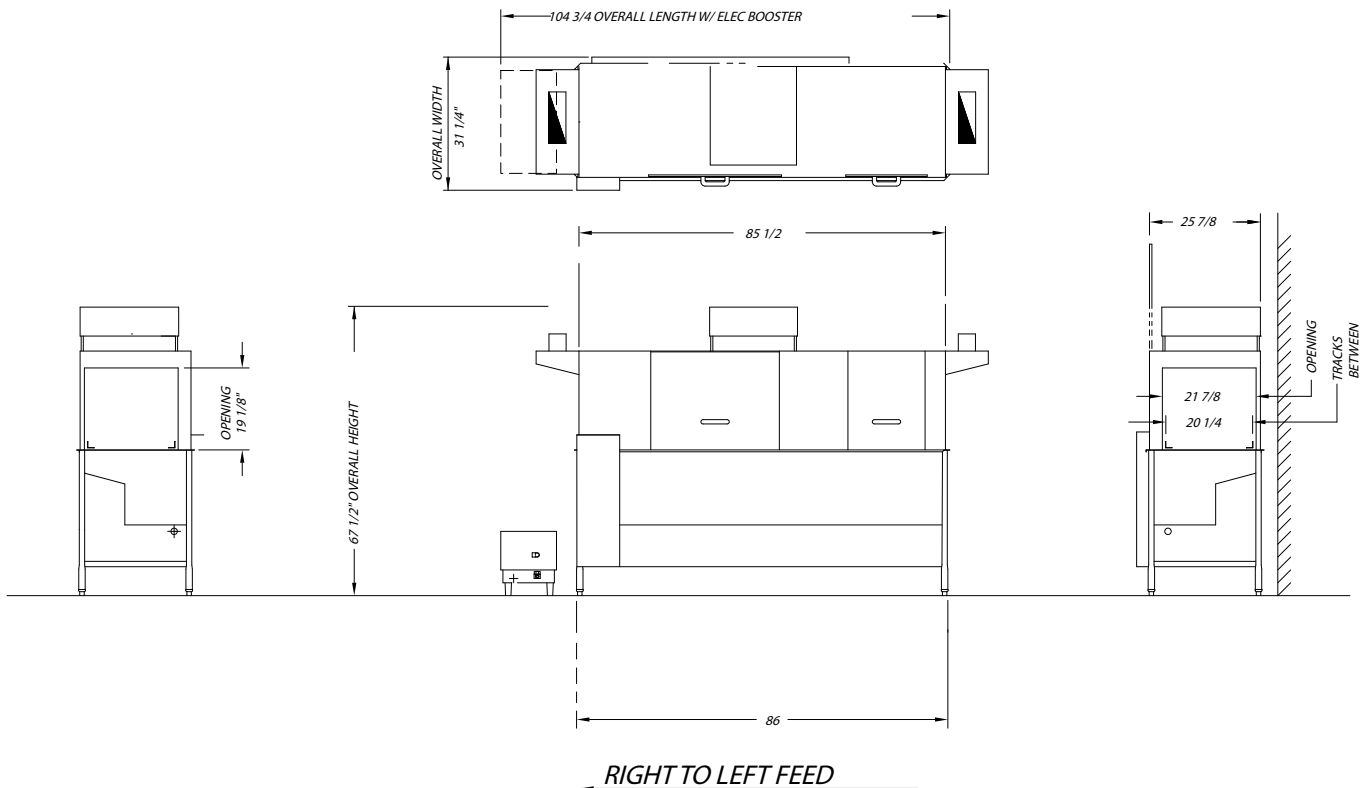

Contact Insinger Sales at 800-344-4802 for an installation drawing specific to your application.
 Note: Due to product improvement we reserve the right to change information and specifications without notice.