



ELITE SERIES REFRIGERATION

SERVING THE FOOD INDUSTRY SINCE 1951

9 CU. FT. ONE-SWING DOOR REFRIGERATION

Model: VR10 Item 41216

Minimum energy consumption with a large footprint that maximizes internal capacity



Establishing a NEW STANDARD in the commercial refrigeration industry.

KEY FEATURES

- BMAD Refrigeration System**
 Ensures rapid and effective cabinet cool down and maintains consistent temperature range with minimum energy consumption
- Electronic Temperature Controller**
 Assures the optimal performance of the cooler, delivering product temperature ideal for consumption.
- High Efficiency Glass Door**
 Equipped with double panel glass and low-e film to reduce condensation. Door hinge is equipped with a self-closing system to ensure the door closes safely, and returns to original position, without any damages.
- LED Lighting System**
 Our LED system uses a fraction of the energy of regular fluorescent lights and requires no replacement for up seven years.
- CFC and HFC Free Cyclopentane Foam**
 Eco-friendly, recyclable and high efficiency cabinet insulation.
- Electronic Fan Motors**
 Enhances performance and efficiency. Uses only a fraction of the energy than industry standard shaded-pole motor requires. Longer lifespan fan motor.
- Low Maintenance Condenser**
 Imbera's finless condenser designed to minimize maintenance. Drastically reduces Total Cost of Ownership. Prevents dust that blocks air flow, to save energy and extend the life of the compressor.



COMMERCIAL REFRIGERATOR
AND/OR FREEZER
9242



NSF/ANSI 7 COMMERCIAL REFRIGERATOR
AND/OR FREEZER
20YY



Authorized Dealer

ELITE SERIES REFRIGERATION

9 CU. FT. SWING DOOR REFRIGERATION



PRODUCT DIMENSION

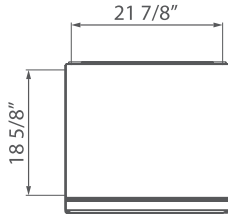

TOP VIEW

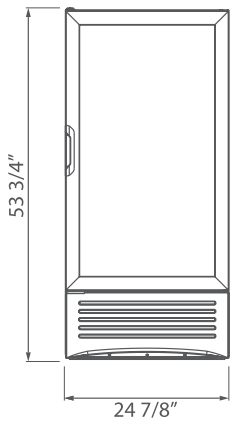

FRONT VIEW

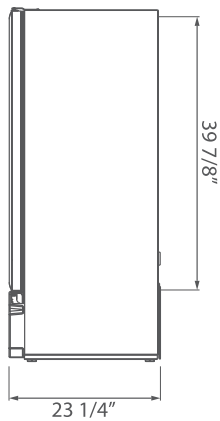

SIDE VIEW

TECHNICAL SPECIFICATIONS

ITEM NUMBER	41216
MODEL	VR10
DESCRIPTION	9 cu.ft. Swing Door Refrigeration
VOLUME	8.9 ft ³ / 253.4 liters
DOORS	1
SHELVES	3
SHELF SIZE	20 7/8" x 17 3/8" / 530mm x 440mm
CAPACITY	20 oz. - Total: 126 Front: 7 12 oz. - Total: 288
TEMPERATURE RANGE	0°C - 7°C / 32°F - 44.6°F
ENERGY CONSUMPTION	1.740 kWh/day*
ELECTRICAL	115 V / 60 Hz / 1 Ph
CORD LENGTH	118" / 3000 mm
HORSEPOWER	1/8
AMPS	3.0
WEIGHT	Gross: 166.4 lbs. / 82 kg. Crated: 185.2 lbs. / 84 kg.
INTERNAL DIMENSIONS (WDH)	21 7/8" x 18 5/8" x 39 7/8" / 555 x 472 x 1013mm
DIMENSIONS (WDH)	24 7/8" x 23 1/4" x 53 3/4" / 632 x 590 x 1365mm

* Energy consumption based on ANSI/ASHRAE Standard 72-2005.

OPTIONS

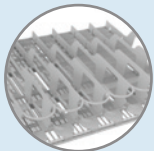

Gravity Kit



Casters

5'9" / 1790mm

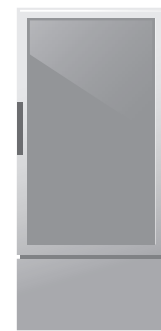
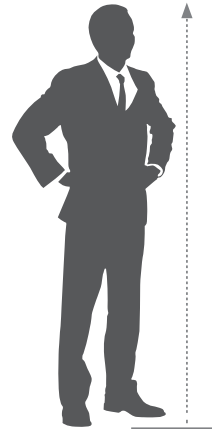

VR 10



COMMERCIAL REFRIGERATOR
AND/OR FREEZER
9242



NSF/ANSI 7 COMMERCIAL REFRIGERATOR
AND/OR FREEZER
20YY

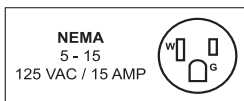

LIMITED WARRANTY
3 YEAR PARTS AND LABOR
5 YEARS PARTS ONLY ON COMPRESSOR

BMAD System (Low maintenance high performance). Dimensions rounded up to the nearest inch or millimeter. Specifications subject to change without notice.

OMCAN INC.

Telephone: 1-800-465-0234

Fax: (905) 607-0234

Email: sales@omcan.com

Website: www.omcan.com



Follow us to keep up to date with the latest news and offers



2015.E.O.E