



Profit from the Eagle Advantage®

Specification Sheet

Short Form Specifications

Eagle worktables, Deluxe series, model _____.
Top constructed of 16 gauge 300 series stainless steel with 1½" roll on front, 4½" backsplash, and sides turned down 90°. Adjustable undershelf constructed of heavy gauge type 430 stainless steel with marine edge. Top reinforced with hat channels and sound deadened. Constructed with uni-lok® patented gusset system with the gussets recessed into the hat channels to reduce lateral movement. 1½"-diameter stainless steel legs, with galvanized gussets and 1" stainless steel adjustable bullet feet.



worktable with backsplash and adjustable undershelf

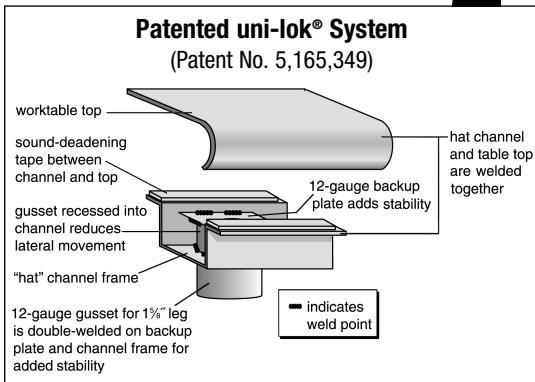

Item No.: _____
Project No.: _____
S.I.S. No.: _____

Worktables with Backsplash and Stainless Steel Base with Undershelf —Deluxe Series

MODELS:

- T2424SEB-BS T24108SEB-BS T3072SEB-BS T3660SEB-BS
- T2430SEB-BS T24120SEB-BS T3084SEB-BS T3672SEB-BS
- T2436SEB-BS T24132SEB-BS T3096SEB-BS T3684SEB-BS
- T2448SEB-BS T24144SEB-BS T30108SEB-BS T3696SEB-BS
- T2460SEB-BS T3030SEB-BS T30120SEB-BS T36108SEB-BS
- T2472SEB-BS T3036SEB-BS T30132SEB-BS T36120SEB-BS
- T2484SEB-BS T3048SEB-BS T30144SEB-BS T36132SEB-BS
- T2496SEB-BS T3060SEB-BS T3648SEB-BS T36144SEB-BS

Tabletop

- Patented uni-lok® gusset system (patent #5,165,349): gussets are recessed into hat channel, reducing lateral movement.
- Top reinforced with welded-on hat channel.
- Sound-deadened between top and channels.
- 4½" (114mm)-high 90° backsplash with 1" (25mm) turn at 90°.
- 1½" (38mm)-diameter 180° rolled edge on front. Ends are turned down 90°, providing for flush installations when required.
- 16 gauge 300 series polished stainless steel.

Adjustable Undershelf

- Heavy gauge stainless steel.
- Gusset welded to each corner.
- Heavy duty marine edge design.

Legs—1½" (41 mm)-diameter

- Tables 96" (2438mm) and longer come with six legs or more.
- Heavy gauge stainless steel.
- 1" (25mm) adjustable stainless steel feet.

Options / Accessories

- Drawer
- Lock
- Casters
- Overshelves
- Power strip (for material handling)
- Knockdown Welded Base (see back page)
- Duplex receptacles
- Pot rack
- Sink
- Additional undershelf
- Stabilizer Bar (for 30"- and 36"-wide tables)

EAGLE GROUP

100 Industrial Boulevard, Clayton, DE 19938-8903 USA
Phone: 302-653-3000 • 800-441-8440 • Fax: 302-653-2065
www.eaglegrp.com
www.eaglegrpnews.com
www.eaglemhc.com

For custom configuration or fabrication needs, contact our SpecFAB® Division.
Phone: 302-653-3000 • Fax: 302-653-2065 • e-mail: quotes@eaglegrp.com

Certifications / Approvals



AutoQuotes



EG10.45B Rev. 07/23

Spec sheets available for viewing, printing or downloading from our online literature library at our websites

Eagle Foodservice Equipment, Eagle MHC, and SpecFAB® are divisions of Eagle Group. ©2023 by the Eagle Group



Item No.: _____
 Project No.: _____
 S.I.S. No.: _____

Worktables with Backsplash and Stainless Steel Base with Undershelf—Deluxe Series

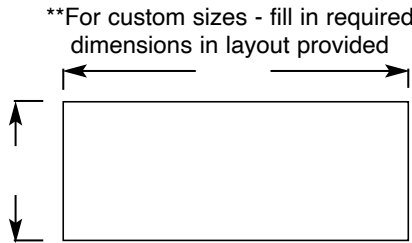

TOP VIEW

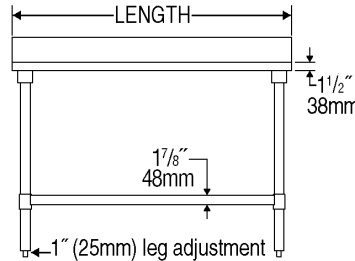

FRONT VIEW

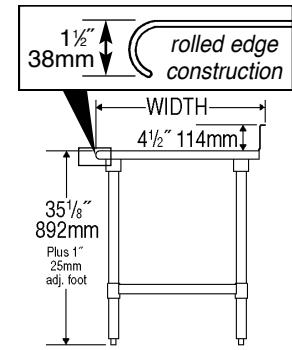

SIDE VIEW

| model # | # of legs | width | | length | | weight | |
|--------------|-----------|-------|-----|--------|------|--------|-------|
| | | in. | mm | in. | mm | lbs. | kg |
| T2424SEB-BS | 4 | 24" | 610 | 24" | 610 | 44 | 20.0 |
| T2430SEB-BS | 4 | 24" | 610 | 30" | 762 | 51 | 23.1 |
| T2436SEB-BS | 4 | 24" | 610 | 36" | 914 | 53 | 24.0 |
| T2448SEB-BS | 4 | 24" | 610 | 48" | 1219 | 67 | 30.4 |
| T2460SEB-BS | 4 | 24" | 610 | 60" | 1524 | 79 | 35.8 |
| T2472SEB-BS | 4 | 24" | 610 | 72" | 1829 | 94 | 42.6 |
| T2484SEB-BS | 4 | 24" | 610 | 84" | 2134 | 132 | 59.9 |
| T2496SEB-BS | 6 | 24" | 610 | 96" | 2438 | 137 | 62.1 |
| T24108SEB-BS | 6 | 24" | 610 | 108" | 2743 | 142 | 64.4 |
| T24120SEB-BS | 6 | 24" | 610 | 120" | 3048 | 154 | 69.9 |
| T24132SEB-BS | 8 | 24" | 610 | 132" | 3353 | 177 | 80.3 |
| T24144SEB-BS | 8 | 24" | 610 | 144" | 3658 | 234 | 106.1 |
| T3030SEB-BS | 4 | 30" | 762 | 30" | 762 | 55 | 25.0 |
| T3036SEB-BS | 4 | 30" | 762 | 36" | 914 | 62 | 28.2 |
| T3048SEB-BS | 4 | 30" | 762 | 48" | 1219 | 77 | 34.9 |
| T3060SEB-BS | 4 | 30" | 762 | 60" | 1524 | 87 | 39.5 |
| T3072SEB-BS | 4 | 30" | 762 | 72" | 1829 | 105 | 47.6 |
| T3084SEB-BS | 4 | 30" | 762 | 84" | 2134 | 132 | 59.9 |
| T3096SEB-BS | 6 | 30" | 762 | 96" | 2438 | 169 | 76.7 |
| T30108SEB-BS | 6 | 30" | 762 | 108" | 2743 | 176 | 79.8 |
| T30120SEB-BS | 6 | 30" | 762 | 120" | 3048 | 182 | 82.6 |
| T30132SEB-BS | 8 | 30" | 762 | 132" | 3353 | 225 | 102.0 |
| T30144SEB-BS | 8 | 30" | 762 | 144" | 3658 | 238 | 107.6 |
| T3648SEB-BS | 4 | 36" | 914 | 48" | 1219 | 84 | 38.1 |
| T3660SEB-BS | 4 | 36" | 914 | 60" | 1524 | 99 | 44.9 |
| T3672SEB-BS | 4 | 36" | 914 | 72" | 1829 | 114 | 51.7 |
| T3684SEB-BS | 4 | 36" | 914 | 84" | 2134 | 183 | 83.0 |
| T3696SEB-BS | 6 | 36" | 914 | 96" | 2438 | 203 | 92.0 |
| T36108SEB-BS | 6 | 36" | 914 | 108" | 2743 | 207 | 93.9 |
| T36120SEB-BS | 6 | 36" | 914 | 120" | 3048 | 211 | 95.7 |
| T36132SEB-BS | 8 | 36" | 914 | 132" | 3353 | 234 | 106.1 |
| T36144SEB-BS | 8 | 36" | 914 | 144" | 3658 | 241 | 109.3 |

NEW Option for Worktables with Stainless Steel Base: Knockdown Welded Base

PATENT PENDING

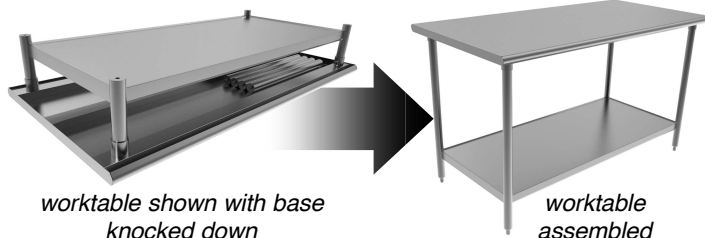

- Precision machined stainless steel threaded inserts pressed into 16 gauge 1 5/8"-diameter leg sections for knockdown construction
- Marine edge stainless steel undershelf welded to lower leg sections

Add suffix **"-KDWB"** to worktable model number (ex: T2436SEB-BS-KDWB). See EG8217 for more info.

EAGLE GROUP
 100 Industrial Boulevard, Clayton, DE 19938-8903 USA
 Phone: 302-653-3000 or 800-441-8440 • Fax: 302-653-2065
 www.eaglegrp.com • www.eaglegrpnews.com • www.eaglehmc.com

Printed in U.S.A.
 ©2023 by Eagle Group

Rev. 07/23

Spec sheets available for viewing, printing or downloading from our online literature library at our websites

Although every attempt has been made to ensure the accuracy of the information provided, we cannot be held responsible for typographical or printing errors. Information and specifications are subject to change without notice. Please confirm at time of order.