



460 Southport Commerce Blvd.
 Spartanburg SC 29306
 Phone: 864-574-6004
 Fax: 864-574-6005
 www.ojedausa.com
 sales@ojedausa.com

Project: _____
 Model #: _____
 Item #: _____ Qty: _____
 Approval: _____

GLASS DOOR MERCHANDISER

RMH-33PT



STEEL CONSTRUCTION

Robust steel construction minimizes the use of plastic materials resulting in an environmentally friendly design.

CARE FREE CONDENSER

The finless spiral condenser design prevents dust/dirt buildup allowing maximum long term efficiency.

PASS THROUGH DUAL DOORS

Self closing double pane sliding glass doors come with door-holding feature. Doors stay open without having to be held, allowing for convenient merchandise stocking.

LED LIGHTING

LED lighting lasts longer than fluorescent lighting, it reducing energy consumption, which generates minimal heat. All of this makes LED lighting great for the environment.

HOT GAS EVAPORATION

Hot gas heated drain pan for condensate evaporation that eliminates the need of floor drains or electric heaters.

OPERATION TEMPERATURE

33°F to 38°F

CUSTOM GRAPHICS

Standard color: black.

Dimensions			Crated Dimensions				Shelves	HP	Voltage	NEMA config	Amps	Crated Weight	
	W	D	H		W	D	H	3	1/3	120	5-15P	3.5	345 lbs
(in)	39.7	28.5	56.7	(in)	42.2	29.7	59.7	Net Capacity (cf): 14			Energy Consumption: 2.09 kw-hr/24 hrs		
(mm)	1007	724	1440	(mm)	1072	754	1516						

*Inches rounded up one decimal place *Specifics may change without notification



CABINET CONSTRUCTION

- High-density, CFC-Free, polyurethane insulation.
- Exterior: Galvanized metal cabinet with powder coated painted surface
- Interior: Easy to clean pre-painted steel.

REFRIGERATION

- Maintenance free condenser
- Automatic defrost cycle
- Hot gas heated pan for condensate evaporation
- Easy to reach components for maintenance
- R-134A refrigerant

LIGHTING

- LED horizontal and vertical lighting

OPERATING CONDITIONS

- The unit is rated for an environment where temperatures remain below 75°F and humidity does not exceed 55%
- Areas with direct sunlight should also be avoided

SHELVING

- 3 Adjustable wire shelves (31.9" x 19.25")

ACCESSORIES

- 6" adjustable stainless steel legs
- Heavy duty casters 3" and 5"
- Shelf product organizer
- Custom graphics

WARRANTY

- 2 year parts and labor warranty
- 5 year compressor

LED LIGHTING



DOOR HOLD FEATURE

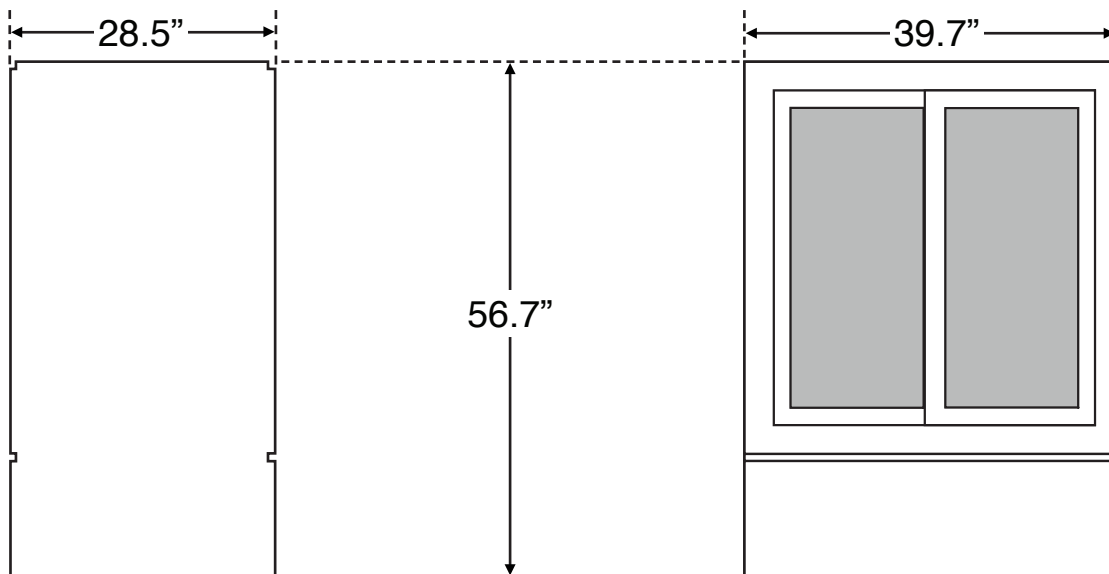

*Specifics may change without notification

