

MULTIPATTY

Manual patty presses



YouTube



- Practical and powerful hamburger press with changeable molds
- Made of anodized aluminium and stainless steel
- Self-centering molds (Patented system) for perfect coupling of mold with buffer
- Machine supplied without molds; allows you to select the molds you require separately
- Automatic hamburger lifting system for easy removal of pieces



Optionals

Changeable mold 4" (3 1/2 to 5 oz.), 5" (5 to 8 oz.), 6" (10 to 14 oz.) 7", (12 to 16 oz.) patties



Optional changeable molds

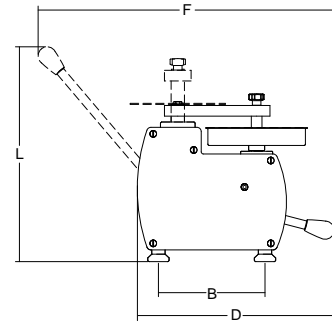
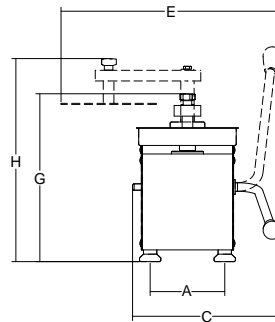

	Mold diameter	A	B	C	D	E	F	G	H	L	Net weight
	inch.	inch.	inch.	inch.	inch.	inch.	inch.	inch.	inch.	inch.	lbs.
Multipatty	-	5 ^{33/64} "	7 ^{7/8} "	10 ^{63/64} "	14 ^{17/32} "	-	21 ^{57/64} "	12 ^{13/32} "	15"	15 ^{29/32} "	17
mold 100	4"	-	-	-	-	14 ^{11/16} "	-	-	-	-	2.20
mold 130	5"	-	-	-	-	15 ^{8/32} "	-	-	-	-	2.31
mold 150	6"	-	-	-	-	15 ^{43/64} "	-	-	-	-	2.42
mold 180	7"	-	-	-	-	16 ^{17/64} "	-	-	-	-	2.64