



CA-3

Automatic Pot & Pan Washer

- 25 Racks Per Hour | 24" x 28"
- Rollers for Easy Rack Swapping
- Available in Corner Configuration
- Made in the USA

STANDARD FEATURES

- Wash tank heat: electric, steam injection
- Pressure regulator
- Low water protection
- Door safety switches
- One vent opening with adjustable damper
- Inspection door
- Vacuum breaker on all incoming water lines
- Capillary thermometer for wash and final rinse
- 304 stainless steel construction
- Stainless steel front panel
- Automatic fill
- Detergent connection provision
- Hold-down rack system
- Manual bypass selector switch
- Side-mounted control panel (NEMA 12)
- Simplified scrap screen design
- Interchangeable upper and lower spray arms

- Standard frame drip proof motor
- Rack assortment- 1 general utility, 1 bake sheet, 1 basket
- Manifold clean-out brush

OPTIONS

- Stainless steel steam coil tank heat
- Steam booster
- Electric booster
- Security package
- Totally enclosed motor
- Pressure reduction valve and line strainer
- Drain quench cooldown
- Door-activated drain closures
- Telescoping doors
- Drain cooldown

SPECIFIER STATEMENT

Specified unit will be an Insinger CA-3 pot and pan washer. Features include pressure regulation, low water protection, inspection door, vacuum breaker on incoming water lines, capillary thermometer, 304 stainless steel construction, automatic fill, hold-down rack system, and manual bypass selector.



SPECIFICATIONS

Capacity	Racks Per Hour	25
	Sheet Pans Per Hour	150
Heating & Venting	Wash Tank Heat	5 kW
	Booster Heat (40°F Rise)	9 kW
	Booster Heat (70°F Rise)	24 kW
	Venting	300 CFM
Water	Water Inlet Temperature	110°F
	Water Consumption (20 PSI)	70 gal/hr
	Wash Tank Capacity	31 gal
	Peak Drain Flow	9 gal/min
Steam	Steam Tank Consumption (20 PSI)	20 lbs/hr
	Steam Consumption (20 PSI, 40°F Rise)	25 lbs/hr
	Steam Consumption (20 PSI, 70°F Rise)	44 lbs/hr
Other	Wash Motor HP	5 (x2)
	Shipping Weight	800

ELECTRICAL

		Electric (CA-3)	9 kw Booster	24 kw Booster
Electrical Options	208/60/3	31.3 amps	38 amps	67.7 amps
	240/60/3	27.9 amps	33 amps	57.8 amps
	380/50/3	17.2 amps	Contact Factory	
	480/60/3	13.9 amps	16.3 amps	29.9 amps
Steam				
Electrical Options	208/60/3	17.4 amps		
	240/60/3	15.9 amps		
	380/50/3	9.6 amps		
	480/60/3	7.9 amps		

TECHNICAL DRAWINGS

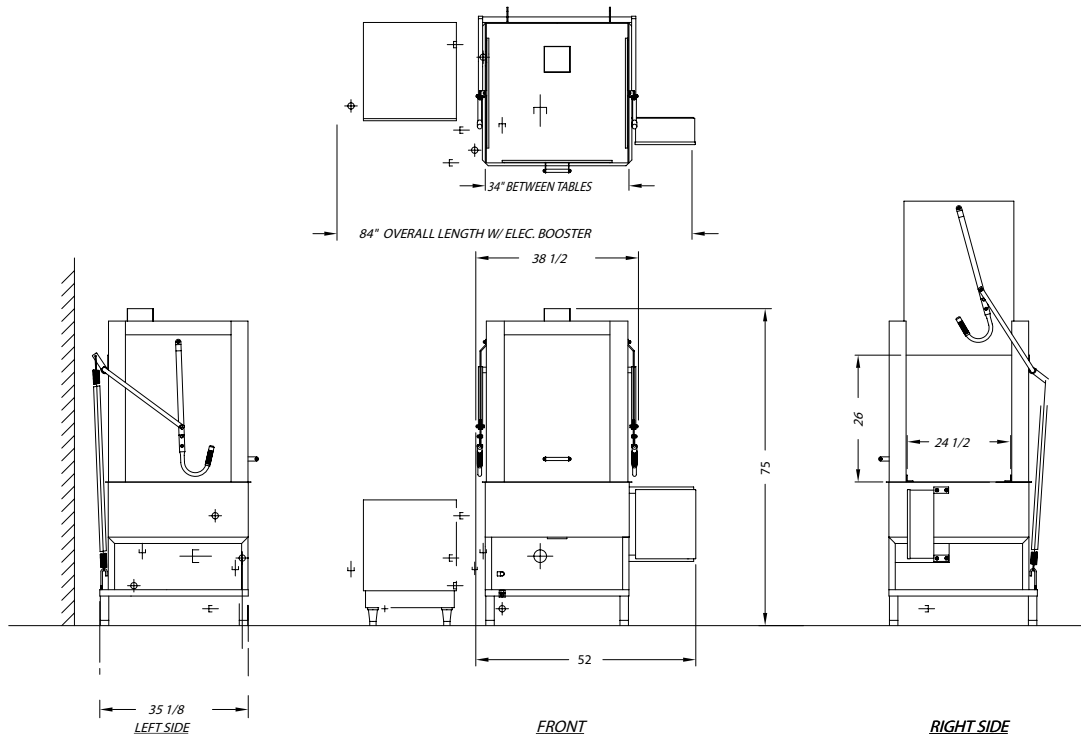

Contact Ininger Sales at 800-344-4802 for an installation drawing specific to your application.
 Note: Due to product improvement we reserve the right to change information and specifications without notice.