





## Technical Data

Packaging Depth	27 3/5 Inches
Shelf Depth	18 Inches
Interior Height	30 1/2 Inches
Packaging Height	41 3/4 Inches
Amps	2.88
Hertz	60 Hertz
Phase	1 Phase
Voltage	115 Volts
Access Type	Doors
BTU (LBP)	974 BTU
Capacity	(3) 1/2 Kegs / 14.8 cu.ft.
Casters	With Casters
Compressor Location	Side Mounted
Countertop Type	Stainless Steel
Door Style	Swing
Door Type	Glass
Plug Type	NEMA 5-15P
Horsepower	1/5
Exterior Finish	Black Automatic defrost Digital Temperature Controller LED Lighting Removable Magnetic Door Gaskets
Material	Black Coated Steel / Stainless Steel
Maximum Ambient Temperature	90 Degrees F
Net Weight	275 lb.
Number of Doors	2
Number of Kegs	3 Kegs
Number of Shelves	4
Refrigerant Capacity	2.47 oz.
Refrigerant Type	R290
Shelf Material	PVC coated shelves
Temperature Range	33 - 40 Degrees F
Top Type	Prep Refrigeration



**HURAKAN**

HKN-GBB2460  
Back Bar Cooler

**Plan View**

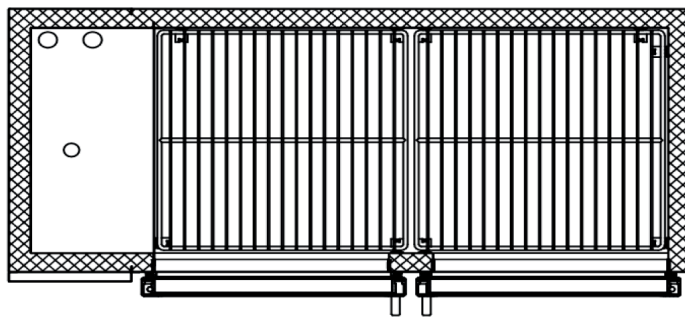
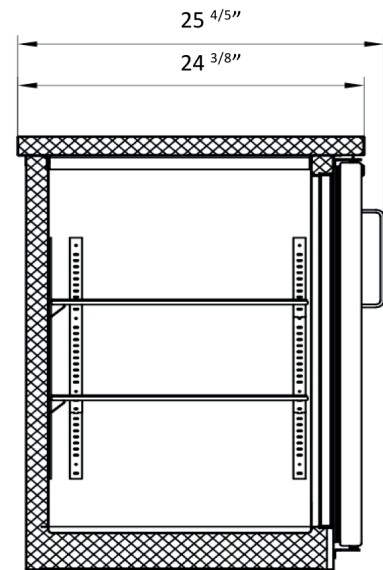
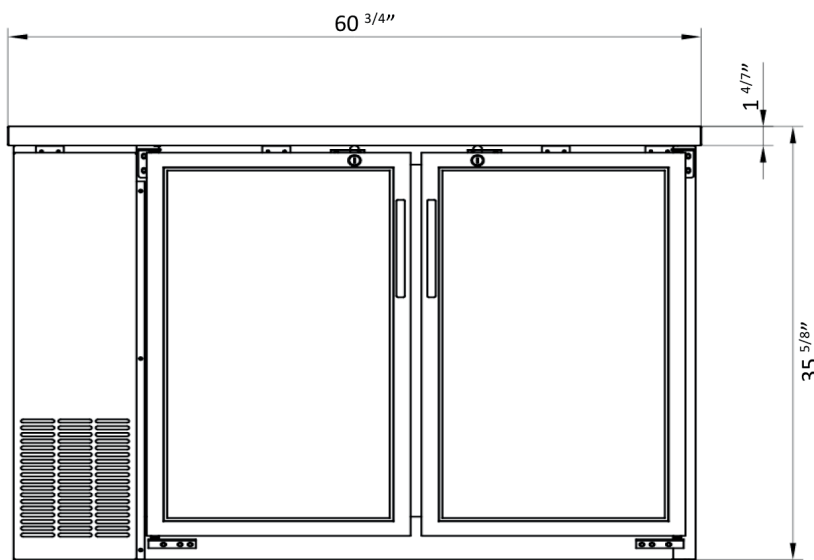



## Notes & Details

This refrigerator unit is meticulously engineered for commercial use, featuring sleek glass doors that add a touch of elegance to any setting. With a packaging depth of 27 3/5 inches and a shelf depth of 18 inches, it offers ample space for beverages and products. The interior height is 30 1/2 inches, while the packaging height is 41 3/4 inches, providing generous storage capacity.

Operating at 115 volts and 60 Hertz with a current draw of 2.88 amps, this refrigerator features doors for convenient access. It has a cooling capacity of 974 BTUs (Low Back Pressure) and a capacity suitable for three half kegs, totaling 18.5 cubic feet.

Its stainless steel countertop, swing-style solid doors with elegant glass panels, and side-mounted compressor ensure durability, efficient cooling, and ease of use. The NEMA 5-15P plug type ensures reliable power connection.

### Notes:

- Stunning glass doors create an attractive display.
- Stylish and durable stainless steel construction.
- Efficient cooling system with auto-defrost function.
- Generous storage capacity suitable for commercial use.
- Reliable power connection with NEMA 5-15P plug type.
- Ideal for bars, restaurants, and hospitality businesses looking to make a statement.