



Job \_\_\_\_\_ Item No. \_\_\_\_\_

## Dual Temperature NSF-7 Hot & Refrigerated Cold Pans

HRCP-7100  HRCP-7200  HRCP-7300  
 HRCP-7400  HRCP-7500



Model HRCP-7200

### DESCRIPTION

Lang electric ranges are 60" wide heavy-duty electric heated units with twin standard ovens in the base. 450°F thermostat and full front landing simplifies and speeds plating.

### SPECIFICATIONS

**Exterior** - One-piece top flange and covered-corner interiors constructed of 18 gauge stainless steel. Exterior body constructed of heavy gauge, corrosion resistant steel. Condensing unit mounted on corrosion resistant frame below the cold pan.

**Interior** - CFC free foamed-in-place insulation through-out, 1" drain located in the center for easy cleaning. Ledge is recessed 3" to comply with NSF-7 requirements, allowing a layer of air to insulate food and for pan support.

**Refrigeration** - Air cooled, type R-513A CFC free refrigerant systems featuring wrapped coil construction on both sides and bottom. Condensing unit may be easily removed for service. Larger compressors speed refrigeration.

**Heating** - Automatic water-fill with high-limit protection featuring a water sensor and solenoid valve to maintain proper water levels. And efficient electric immersion heating system transfers heat directly to the water while a positive off thermostat controls provides adjustable and consistent temperatures. Designed for wet operation only.

### STANDARD FEATURES

- NSF-7 compliant with 3" recessed top edge
- Self-contained drop-in design
- Hold standard 12" by 20" food pans and fractional sized pans
- Stainless steel top and liner for maximum strength and durability
- 1" drains for ease of cleaning
- Single control for changing from hot to cold operation.
- Easy access temperature & function control panel attached to a 24" long flexible conduit for optional counter mounting
- Type R-513A CFC free refrigerant
- Fully insulated, CFC free, foamed-in place insulation keeps food cold while saving energy
- Recessed ledge for pan support and colder, fresher products
- Adapter bars provided for food pans
- Limited 1 year parts & labor warranty

### OPTIONS & ACCESSORIES

- Perforated bottom strainer plate conveniently holds ice above drain to prevent clogging
- Adapter bars for fractional sized pans
- 2nd year parts & labor warranty
- 5-year compressor warranty

### CERTIFICATIONS



**WELLS MANUFACTURING INTERNATIONAL INC.**  
265 Hobson Street • Smithville, Tennessee 37166  
Telephone 800 264 7827 • [www.wells-mfg.com](http://www.wells-mfg.com)

Printed in the U.S.A. 2M-Z25091 REV C (12-24)  
Specifications are subject to change without notice  
and are not intended for installation purposes.



# Dual Temperature NSF-7 Hot & Refrigerated Cold Pans

□HRCP-7100 □HRCP-7200 □HRCP-7300  
□HRCP-7400 □HRCP-7500

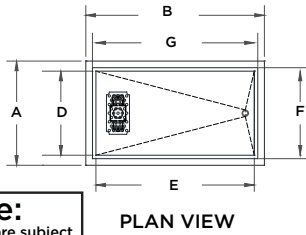

**Note:**  
Specifications are subject to change without notice and are not intended for installation purposes. See installation instructions prior to installing unit.

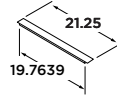

PAN DIVIDER  
TWO INCLUDED

COUNTER CUTOUT  
45 1/4" X 25 7/8"

HRCP-7300 Shown

NOTE: RAILS ARE SHIPPED AS FOUR (4) SEPARATE PIECES-NOT WELDED

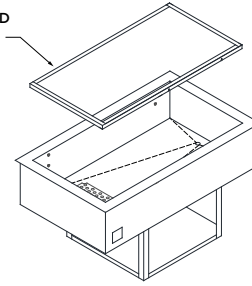

ISOMETRIC VIEW

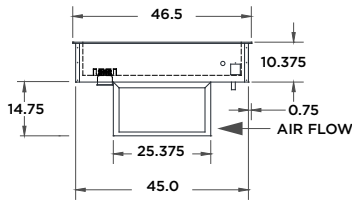

FRONT ELEVATION  
(OPERATOR SIDE)

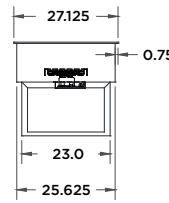

SIDE ELEVATION

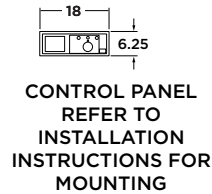

CONTROL PANEL  
REFER TO  
INSTALLATION  
INSTRUCTIONS FOR  
MOUNTING

SK3252 REV - (12-24)

SPECIFICATIONS								SHIPPING INFORMATION						
MODEL	OVERALL DIMENSIONS			INTERIOR DIMENSIONS		CUT OUT DIMENSIONS		WEIGHTS		CARTON DIMENSIONS			CRATE SIZE	
	A Front to Back Inches (MM)	B Left to Right Inches (MM)	C Height Inches (MM)	D Front to Back Inches (MM)	E Left to Right Inches (MM)	F Front to Back Inches (MM)	G Left to Right Inches (MM)	SHIPPING WEIGHT POUNDS (KG)	INSTALLED WEIGHT POUNDS (KG)	WIDTH Inches (MM)	DEPTH Inches (MM)	HEIGHT Inches (MM)	CUBIC FEET	CUBIC METERS
HRCP-7100	27-1/8 (689)	19-1/8 (468)	25-1/8" (638)	21-7/8 (555)	13-7/8 (352)	25-7/8 (657)	17-7/8 (451)	175 (80)	150 (69)	21 (533)	29 (737)	32 (813)	11.3	0.31
HRCP-7200	27-1/8 (689)	19-1/8 (468)	25-1/8" (638)	21-7/8 (555)	27-1/2 (699)	25-7/8 (657)	31-1/2 (800)	220 (100)	190 (87)	29 (737)	34 (864)	32 (813)	18.3	0.52
HRCP-7300	27-1/8 (689)	19-1/8 (468)	25-1/8" (638)	21-7/8 (555)	41-1/4 (1048)	25-7/8 (657)	45-1/4 (1149)	240 (109)	210 (96)	29 (737)	48 (1219)	32 (813)	25.8	0.73
HRCP-7400	27-1/8 (689)	19-1/8 (468)	25-1/8" (638)	21-7/8 (555)	55 (1397)	25-7/8 (657)	59 (1499)	275 (125)	240 (109)	29 (737)	62 (1575)	32 (813)	33.3	0.94
HRCP-7500	27-1/8 (689)	19-1/8 (468)	25-1/8" (638)	21-7/8 (555)	68-3/4 (1747)	25-7/8 (657)	72-3/4 (1847)	298 (136)	255 (116)	29 (737)	76 (1930)	32 (813)	41.0	1.16

POWER SUPPLY INFORMATION										
MODEL	WARMER				REFRIGERATION					SINGLE PHASE SUPPLY 3-WIRE 120/208-240V L1-L2 208-240V L2-N 120V 60HZ
	VOLTS	KW	AMPS		VOLTS	HP	AMPS		REFRIGERANT TYPE	
			L1-L2	N			L2-N	L1		
HRCP-7100	208	1.9	9.0	N.A.	115	1/5	4	N.A.	R-513A	
	240	2.5	10.4	N.A.						
HRCP-7200	208	1.9	9.0	N.A.	115	1/4	5	N.A.	R-513A	
	240	2.5	10.4	N.A.						
HRCP-7300	208	3.0	14.4	N.A.	115	1/4	5	N.A.	R-513A	
	240	4.0	16.7	N.A.						
HRCP-7400	208	3.8	18.1	N.A.	115	1/4	5	N.A.	R-513A	
	240	5.0	20.8	N.A.						
HRCP-7500	208	6.0	28.9	N.A.	115	1/3	8	N.A.	R-513A	
	240	8.0	33.3	N.A.						

All HRCP models feature automatic water fill systems and require a water supply connection. Please refer to the operator's manual and installation instructions for details.

Due to periodic changes in designs, methods, procedures, policies and regulations, the specifications contained in this sheet are subject to change without notice. While Star Manufacturing exercises good faith efforts to provide information that is accurate, we are not responsible for errors or omissions in information provided or conclusions reached as a result of using the specifications. By using the information provided, the user assumes all risks in connection with such use.



**WELLS MANUFACTURING INTERNATIONAL INC.**  
265 Hobson Street • Smithville, Tennessee 37166  
Telephone 800 264 7827 • www.wells-mfg.com

Printed in the U.S.A. 2M-Z25091 REV C (12-24)  
Specifications are subject to change without notice and are not intended for installation purposes.