





## Technical Data

Packaging Depth	27 3/5 Inches
Shelf Depth	18 Inches
Interior Height	30 1/2 Inches
Packaging Height	41 3/4 Inches
Amps	2.88
Hertz	60 Hertz
Phase	1 Phase
Voltage	115 Volts
Access Type	Doors
BTU (LBP)	974 BTU
Capacity	(2) 1/2 Kegs / 11,2 cu.ft.
Casters	With Casters
Compressor Location	Side Mounted
Countertop Type	Stainless Steel
Door Style	Swing
Door Type	Glass
Plug Type	NEMA 5-15P
Horsepower	1/5
Exterior Finish	Black Automatic defrost Digital Temperature Controller LED Lighting Removable Magnetic Door Gaskets
Material	Black Coated Steel / Stainless Steel
Maximum Ambient Temperature	90 Degrees F
Net Weight	231 lb.
Number of Doors	2
Number of Kegs	2 Kegs
Number of Shelves	4
Refrigerant Capacity	2.47 oz.
Refrigerant Type	R290
Shelf Material	PVC coated shelves
Temperature Range	33 - 40 Degrees F
Top Type	Prep Refrigeration



## Plan View

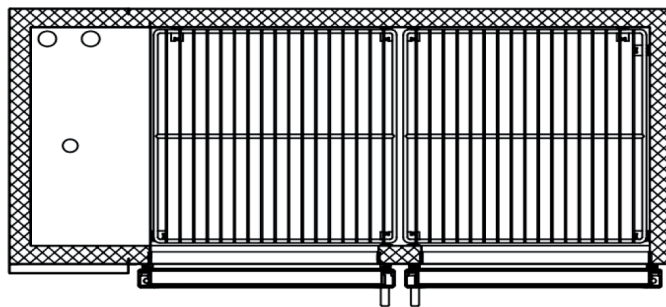
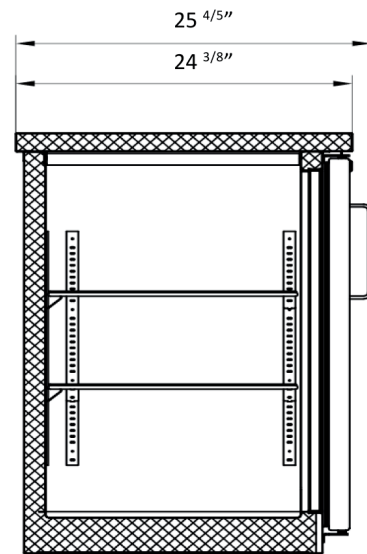
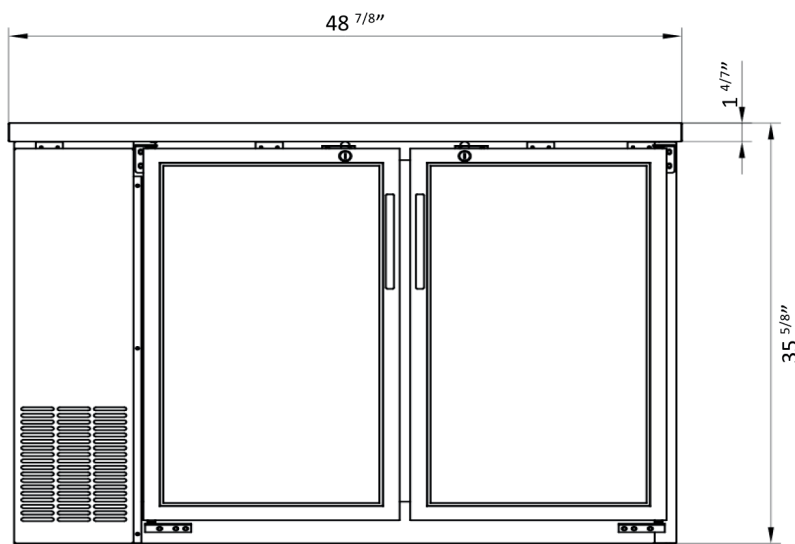



## Notes & Details

The HKN-GBB2448G Back Bar Cooler with dual glass doors is a versatile and stylish solution for commercial beverage storage and display. Let's delve into its key features and benefits:

1. **Spacious Display:** The dual glass doors provide a clear view of the beverages stored inside, creating an enticing display that attracts customers and enhances product visibility.
2. **Optimized Storage:** With dimensions tailored for commercial use, this cooler offers ample space to accommodate (2) 1/2 kegs, totaling 11.2 cubic feet of storage capacity. The layout is designed for organization and easy access to beverages.
3. **Efficient Cooling System:** Equipped with a robust compressor boasting 974 BTUs (LBP), this cooler delivers efficient and consistent cooling performance, ensuring beverages are maintained at the perfect serving temperature.
4. **Durable and Stylish Design:** The stainless steel countertop paired with dual glass doors not only ensures durability but also adds a touch of elegance to any commercial space. The unit is built to withstand the demands of daily use in busy establishments.
5. **Convenient Access:** The dual glass swing doors provide convenient access to beverages, allowing staff to serve customers promptly and efficiently.
6. **Energy Efficiency:** The design of the glass doors minimizes energy loss while effectively maintaining internal temperatures, contributing to energy efficiency and cost savings over time.

In summary, the HKN-GBB2448G Back Bar Cooler with dual glass doors offers functionality, style, and efficiency, making it an excellent choice for businesses looking to showcase their beverage selection while maintaining optimal storage conditions.