



Model: **17-XXXL** Item #: \_\_\_\_\_ Date: \_\_\_\_\_  
 Project: \_\_\_\_\_ Qty: \_\_\_\_\_ Approved By: \_\_\_\_\_

# Pre-Rinse Less Base

# ROYAL SERIES PLUMBING



## Replacement Parts

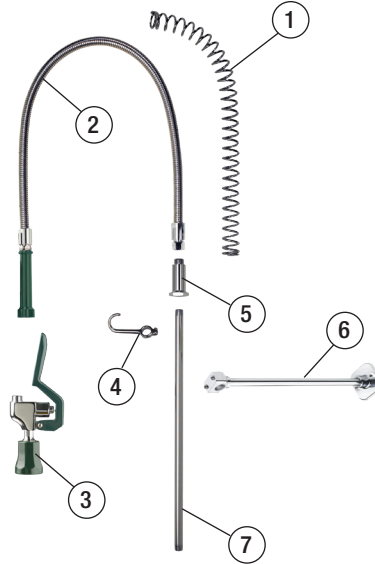

NO.	Item	Model
1	24" Spring	21-162
2	44" Hose w/ Grip	21-133L
3	Spray Head	21-129L
4	Hook Assembly	21-165
5	Spring Retainer	21-161L
6	Wall Bracket	21-137
7	18" Riser	21-160L

## Standard Features

- Pre-assembled to cut installation time
- Interchangeable with most brands
- Built for high volume
- Full replacement parts available

## Specifications

- 35" high w/ 15" overhang
- 1.2 GPM spray head
- Includes wall bracket & hook assembly
- 44" stainless steel hose with grip
- Temperature range of 40° to 180°
- Riser Pipe with Hook: 3/8" NPT x 18"

## Product Compliance

- NSF/ANSI 61-G
- ASME A112.18.1/CSA B125.1
- City of Los Angeles
- CEC Listed
- Commonwealth of Massachusetts



⚠ Warning: This product can expose you to chemicals including lead and lead compounds which are known to the State of California to cause cancer and birth defects or other reproductive harm. For more information go to [www.P65Warnings.ca.gov](http://www.P65Warnings.ca.gov).

