

High capacity,  
small  
footprint

MCC Hot full serve  
humidified  
3 levels

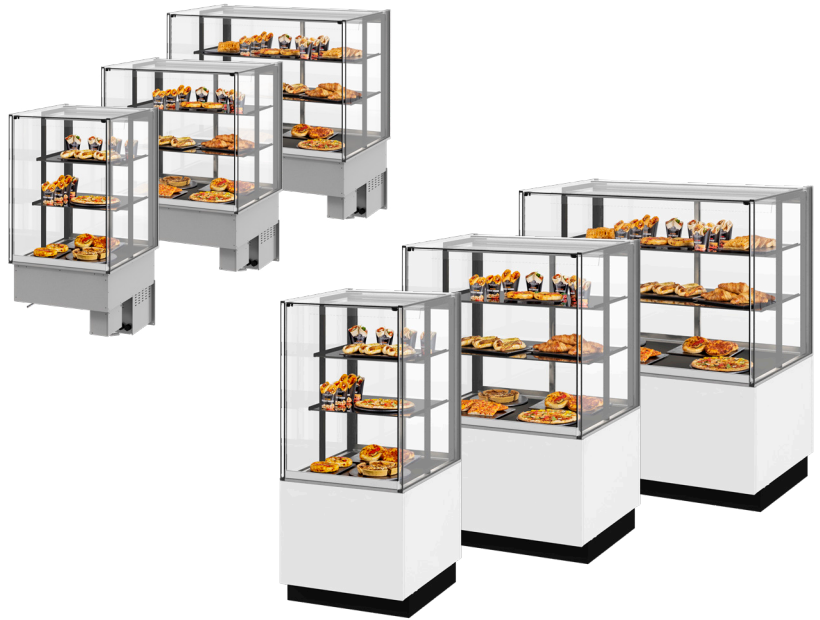

## The Modular Convenience Counters offer you the best, in every aspect



High Capacity

Highest capacity on a small footprint: Up to 30%\* more display surface



Up to 75%\* more product visibility due to transparent sides and top



Best Performance

Maximum food safety, extended shelf life and less waste



Mix & Match

Unlimited possibilities and combinations with other MCC models



Green Efficiency

Low total cost of ownership & environmental friendly green technologies

\*Compared to competition according to global ISO standards - TDA ISO 23953

### MCC Hot full serve display

- 3-level heated and humidified full serve display cabinet
- Designed for unpackaged products
- 24, 36 or 48 inches wide
- Unlimited possibilities in combining hot and cold, side-by-side
- Available as pass-through model, with soft closing and sliding glass doors on the operator side
- Available as floor model and as drop-in, adaptable to any store design
- Ready to plug in for quick and easy installation
- Underframe floor model available in any RAL colour
- Slim shelves with adjustable angle and height
- LED lighting with natural colour reproduction on each shelf
- Patented Hot Blanket holding technology keeps products at  $\geq 150^{\circ}\text{F}$
- Humidification
- Thermo pane glass - increased insulation
- Optional point-of-sales price strips
- Total presentation area:
  - MCC 24-3: 8.1 ft<sup>2</sup>
  - MCC 36-3: 12.9 ft<sup>2</sup>
  - MCC 48-3: 17.9 ft<sup>2</sup>
- Also available as
  - MCC Hot self serve open display
  - MCC Hot self serve humidified with doors on customer side



Three presentation levels



Hot Blanket holding technology



Optimal visibility



Floor model or drop-in version

	MCC 24-3 Hot FS	MCC 36-3 Hot FS	MCC 48-3 Hot FS
Width	23 5/8"	35 7/16"	47 1/4"
Depth	29 1/2"	29 1/2"	29 1/2"
Height on stand	55 7/8"	55 7/8"	55 7/8"
Height drop-in above worktop	33 1/16"	33 1/16"	33 1/16"
Voltage	1~ 208 V	1~ 208 V	1~ 208 V
Frequency	50/60 Hz	50/60 Hz	50/60 Hz
Power	1.72 kW	2.09 kW	2.79 kW

## MCC Hot FS on stand

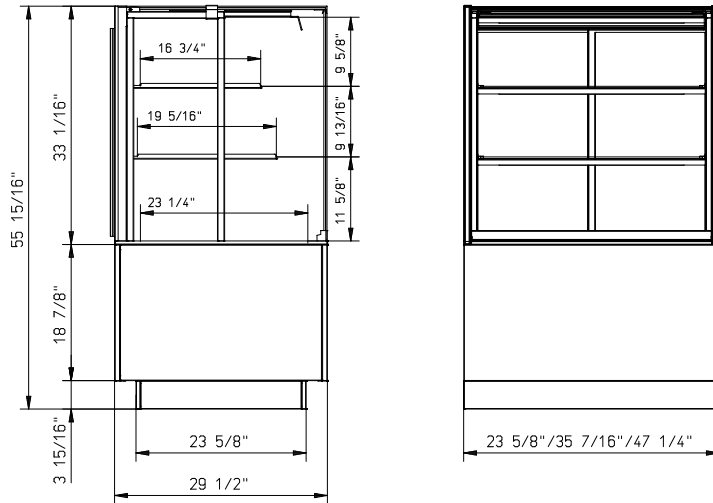

## MCC Hot FS drop-in

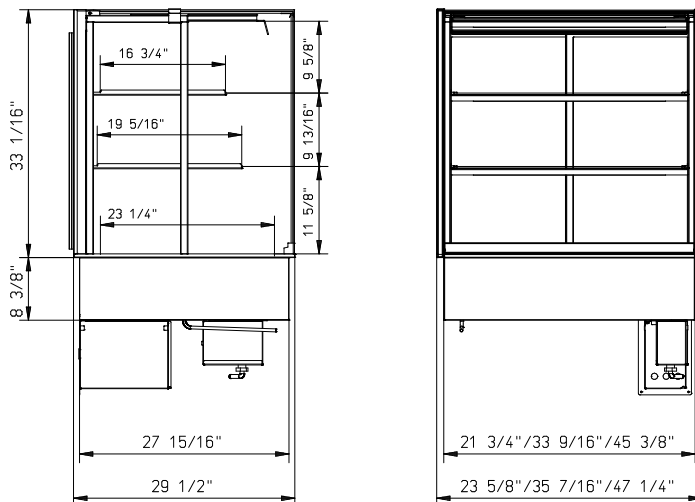

Specifications and technical data are subject to amendment without notice.

These are basic drawings. For more detailed technical information, please refer to the installation manual at [www.frijado.com](http://www.frijado.com).

The MCC Hot FS is ETL listed (meets UL standard 197, NSF standard 4 and CSA standard C22.2 no. 109).



Fri-Jado Inc.  
 1401 Davey Road  
 Suite 100  
 Woodridge IL 60517  
 Toll free 877-374-5236  
 e-mail [us.info@frijado.com](mailto:us.info@frijado.com)  
[www.frijado.com](http://www.frijado.com)