

Specification Sheet

Short Form Specifications

BlendPort[®] Back Bar Refrigeration, model _____.
 Steel cabinet exterior wrapped in durable black vinyl. Interior utilizes stainless steel walls, floor and ceiling. Glass doors are easily interchangeable. 120/60/1-phase electricity. Utilizes 15-amp dedicated outlet. Cord and NEMA 5-15P plug. Maintains temperature of 33°F to 41°F. Easy access to condenser.



Item No.:	_____
Project No.:	_____
S.I.S. No.:	_____

Back Bar Refrigeration

MODELS:

- BPR-UBB-24-48G**
- BPR-UBB-24-60G**
- BPR-UBB-3G**
- BPR-UBB-24-72G**
- BPR-UBB-4G**

Design & Construction Features

- Stainless steel top.
- Black vinyl-clad steel cabinet.
- Glass doors with extruded pull handle.
- Doors are hinged and provided with key lock.
- Stainless steel interior lining with stainless steel floor.
- Lengths available range from 48" to 90".
- Interior LED lighting to highlight display.
- Self-contained refrigeration.
- Maintains temperature between 33°F and 41°F.
- One year parts and labor warranty and five year compressor warranty.

Item No.:	
Project No.:	
S.I.S. No.:	

Back Bar Refrigeration

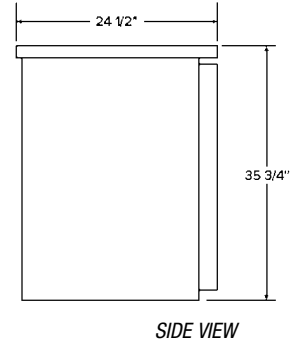
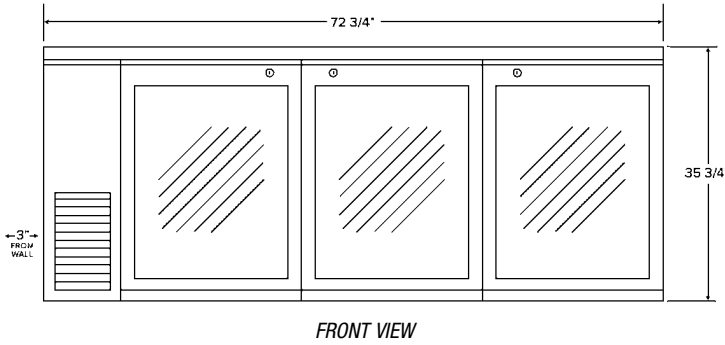
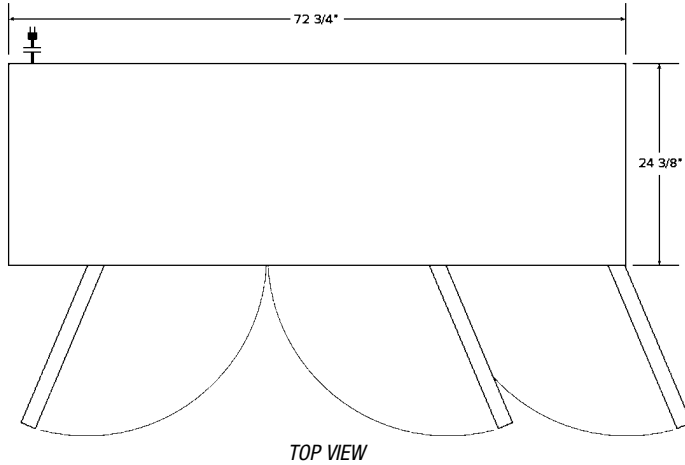

(model #BPR-UBB-24-72G shown)

width		length		height		no. of doors	no. of shelves	capacities			electrical data*	weights	model #
in.	mm	in.	mm	in.	mm			12-oz. cans	12-oz. bottles	1/2-barrel kegs			
24 ³ / ₈ "	619	48 ³ / ₈ "	1238	35 ³ / ₈ "	908	2	4	546	336	2	1/3-HP, 120V, 6.4A	254 lbs.	BPR-UBB-24-48G
24 ³ / ₈ "	619	60 ³ / ₈ "	1543	35 ³ / ₈ "	908	2	4	756	456	2	1/3-HP, 120V, 7.5A	290 lbs.	BPR-UBB-24-60G
27 ³ / ₈ "	705	69 ³ / ₈ "	1756	36 ¹ / ₄ "	921	2	4	1,134	594	3	1/3-HP, 120V, 8.0A	370 lbs.	BPR-UBB-3G
24 ³ / ₈ "	619	72 ³ / ₈ "	1848	35 ³ / ₈ "	908	3	6	966	576	3	1/3-HP, 120V, 8.0A	386 lbs.	BPR-UBB-24-72G
27 ³ / ₈ "	705	90 ³ / ₈ "	2296	36 ¹ / ₄ "	921	3	6	1542	834	4	1/2-HP, 120V, 10A	432 lbs.	BPR-UBB-4G

* All units are 60-cycle single-phase.

All units feature one-year parts and labor warranty and five-year compressor warranty.

BlendPort[®]

An Eagle Group Company
100 Industrial Boulevard, Clayton, DE 19938-8903 USA
Phone: 800-441-8440 • Fax: 302-653-2065

Printed in U.S.A.
©2023 by Eagle Group
Rev. 03/23

Although every attempt has been made to ensure the accuracy of the information provided, we cannot be held responsible for typographical or printing errors. Information and specifications are subject to change without notice. Please confirm at time of order.