





## Technical Data

|                             |   |
|-----------------------------|---|
| Packaging Depth             | 27 3/5 Inches   |
| Shelf Depth                 | 18 Inches   |
| Interior Height             | 30 1/2 Inches   |
| Packaging Height            | 41 3/4 Inches   |
| Amps                        | 2.88  |
| Hertz                       | 60 Hertz  |
| Phase                       | 1 Phase   |
| Voltage                     | 115 Volts   |
| Access Type                 | Doors   |
| BTU (LBP)                   | 974 BTU   |
| Capacity                    | (2) 1/2 Kegs / 11,2 cu.ft.  |
| Casters                     | With Casters  |
| Compressor Location         | Side Mounted  |
| Countertop Type             | Stainless Steel   |
| Door Style                  | Swing   |
| Door Type                   | Glass   |
| Plug Type                   | NEMA 5-15P  |
| Horsepower                  | 1/5   |
| Exterior Finish             | Black<br>Automatic defrost<br>Digital Temperature Controller<br>LED Lighting<br>Removable Magnetic Door Gaskets |
| Material                    | Black Coated Steel / Stainless Steel  |
| Maximum Ambient Temperature | 90 Degrees F  |
| Net Weight                  | 231 lb.   |
| Number of Doors             | 2   |
| Number of Kegs              | 2 Kegs  |
| Number of Shelves           | 4   |
| Refrigerant Capacity        | 2.47 oz.  |
| Refrigerant Type            | R290  |
| Shelf Material              | PVC coated shelves  |
| Temperature Range           | 33 - 40 Degrees F   |
| Top Type                    | Prep Refrigeration  |



## Plan View

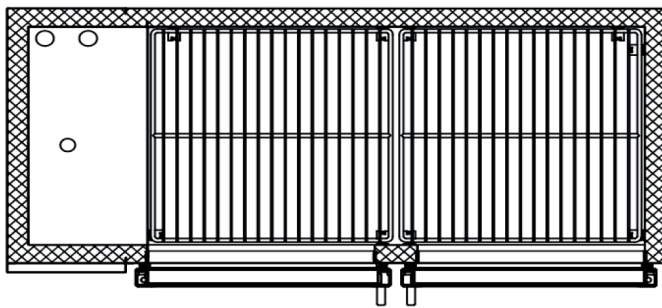
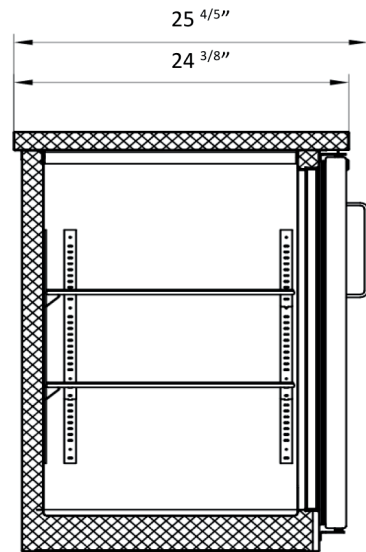
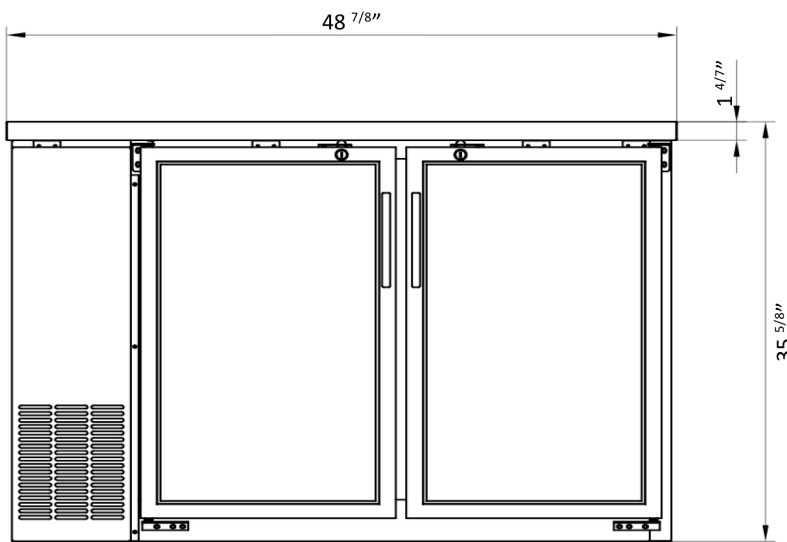



## Notes & Details

The HKN-GBB2448 Back Bar Cooler is meticulously engineered to cater to the rigorous demands of commercial establishments, ensuring seamless operations and customer satisfaction. Let's delve deeper into its standout features and benefits:

- 1. Ample Storage Space:** With dimensions optimized for commercial use, this cooler provides generous storage capacity for beverages, including the capability to accommodate (2) 1/2 kegs, totaling 11.2 cubic feet of storage.
- 2. Efficient Cooling System:** Equipped with a powerful compressor boasting 974 BTUs (LBP), this cooler swiftly and consistently maintains the desired temperature, preserving the quality and freshness of beverages.
- 3. Durable Construction:** The HKN-GBB2448 is built to last, featuring a robust stainless steel countertop that withstands daily wear and tear while exuding a professional appearance that complements any commercial setting.
- 4. Convenient Access:** Its solid swing doors provide convenient access to stored beverages, allowing staff to efficiently serve customers without compromising on cooling performance.
- 5. Energy Efficiency:** The solid doors and side-mounted compressor contribute to energy efficiency by minimizing temperature fluctuations and reducing energy consumption, resulting in cost savings for the establishment.

In conclusion, the HKN-GBB2448 Back Bar Cooler is not just a functional appliance but a strategic investment for bars, restaurants, and hospitality businesses seeking reliable beverage storage and cooling solutions that elevate customer experiences.